

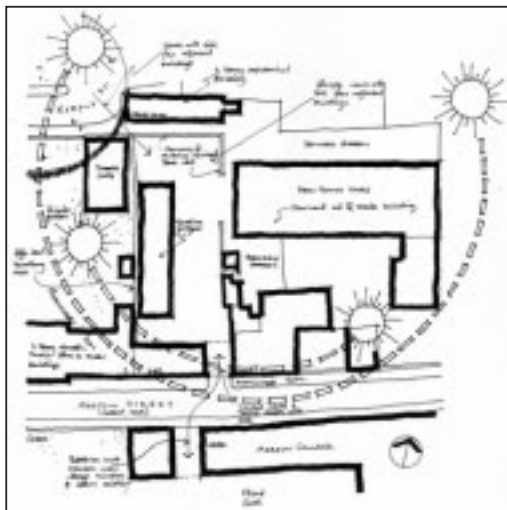

## New administration building for Merton College

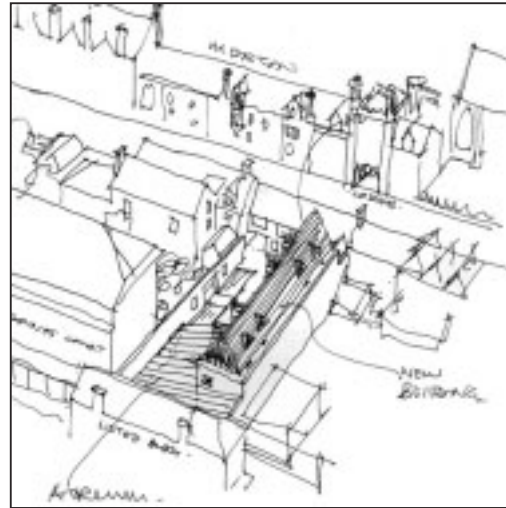

- CONSERVATION
- RESIDENTIAL
- EDUCATION/COMMUNITY**
- HOTEL/LEISURE
- HEALTHCARE
- COMMERCIAL

Acanthus Clews were invited, in competition, to design a new office administration building for Merton College, Oxford.

The site was located opposite the main complex, entered through an archway from the street. It was very sensitive and restricted, with existing buildings on all sides.

In order to meet the demands of the brief a three storey block was designed with additional usable space within a basement level lit by a glazed atrium roof. Due to the sensitivity of the site the top floor accommodation was created within the roof space. External materials of stone, render and slates were selected to relate sympathetically to the surroundings.